

# SOLID CARBIDE DRAWING DIES

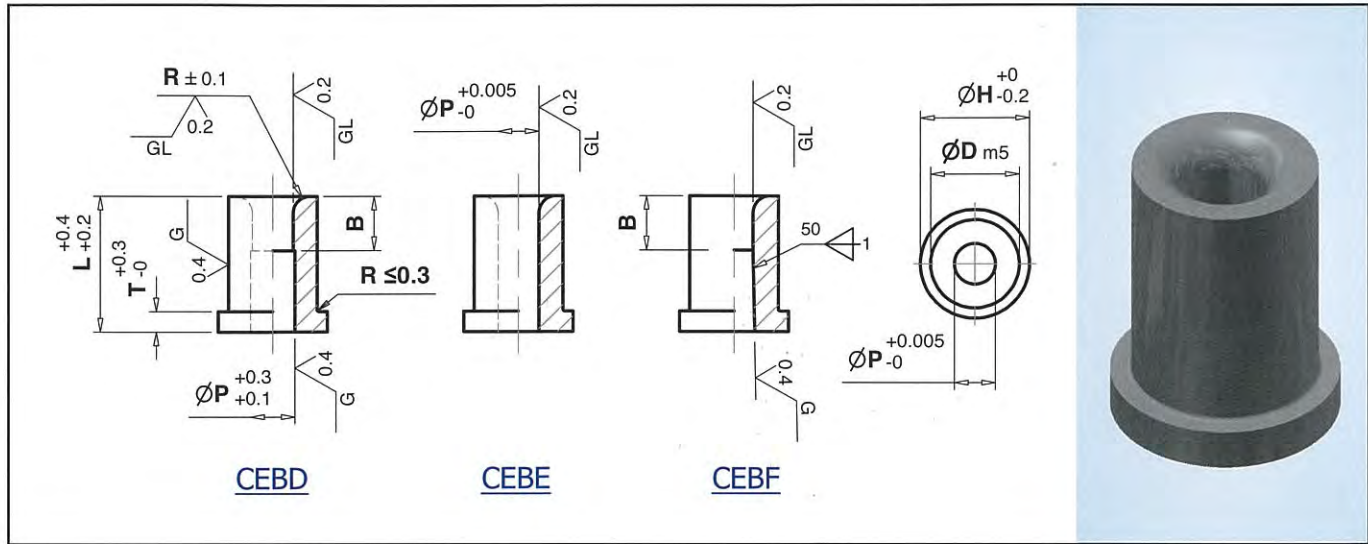

- HEAD TYPE, STEPPED (**CEBD**)
- HEAD TYPE, STRAIGHT (**CEBE**)
- HEAD TYPE, TAPERED (**CEBF**)



D Body Dia.	P Hole Dia.	B	H Head Dia.	T Head Height	L – Length			
					16	20	22	25
6.0	1.000 – 4.000	For <b>CEBD</b> , $B \leq P \times 3$  For <b>CEBF</b> , $B \leq (L/2) + 2$	9	5	•	•	•	•
8.0	1.000 – 5.000		11	5	•	•	•	•
10.0	2.000 – 7.000		13	5	•	•	•	•
13.0	3.000 – 8.500		16	5	•	•	•	•
16.0	5.000 – 10.000		19	5	•	•	•	•
20.0	7.000 – 13.000		23	5	•	•	•	•
25.0	9.000 – 18.000		28	5	•	•	•	•

Note: Other Dimension Not Listed above can be ground to your specifications.  
If in doubt please send us your drawing. 'D' tolerance is m5 or +0.005.

$$***0.2 \leq R < (D - P - 2)/2$$

How to order : **CEBD – D – P – B – R – L**  
Example : **CEBF – D6.0 – P1.000 – B6 – 16**

# SOLID CARBIDE DRAWING DIES

- STRAIGHT TYPE, STEPPED (**CECD**)
- STRAIGHT TYPE, STRAIGHT (**CECE**)
- STRAIGHT TYPE, TAPERED (**CECF**)

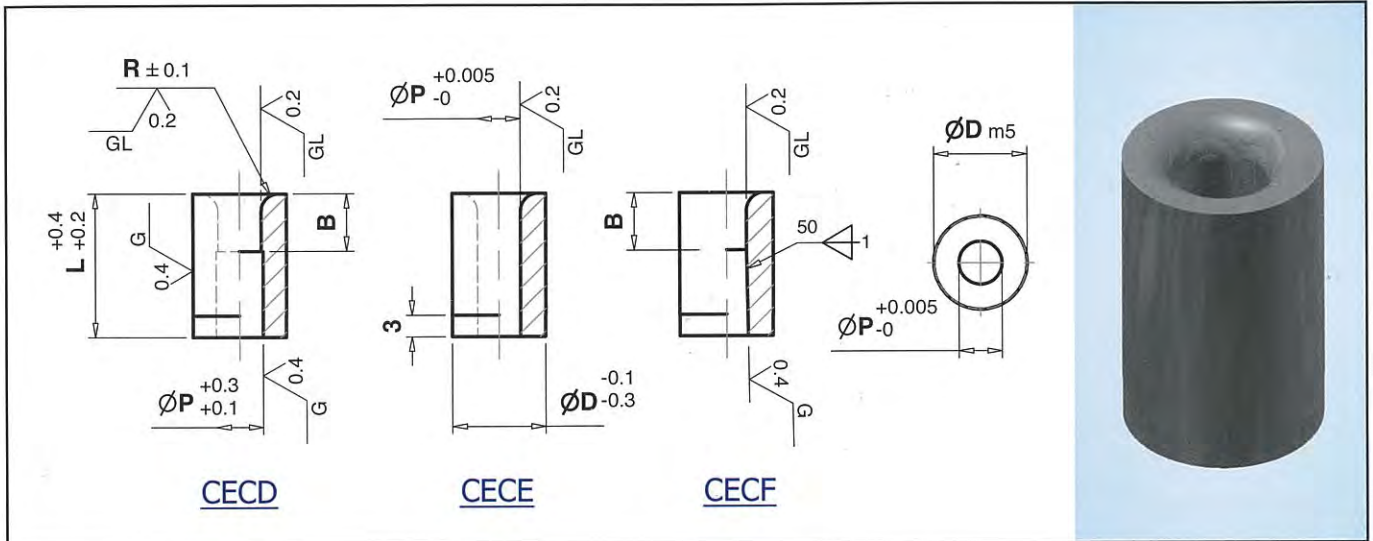

D Body Dia.	P Hole Dia.	B	L – Length			
			16	20	22	25
6.0	1.000 – 4.000	For <b>CECD</b> , $B \leq P \times 3$  For <b>CECF</b> , $B \leq (L/2) + 2$	•	•	•	•
8.0	1.000 – 5.000		•	•	•	•
10.0	2.000 – 7.000		•	•	•	•
13.0	3.000 – 8.500		•	•	•	•
16.0	5.000 – 10.000		•	•	•	•
20.0	7.000 – 13.000		•	•	•	•
25.0	9.000 – 18.000		•	•	•	•

$$***0.2 \leq R < (D - P - 2)/2$$

Note: Other Dimension Not Listed above can be ground to your specifications.  
If in doubt please send us your drawing. 'D' tolerance is m5 or +0.005.

How to order : **CECD – D – P – B – R – L**  
Example : **CECF – D6.0 – P1.000 – B6 – 16**